

TITLE: LC Duplex Adapter, Multi-mode
with Ceramic Sleeve, Beige Housing

- MATERIAL:**
1. ADAPTER BODY: ENGINEERING PLASTIC "PEI", COLOR BEIGE.
 2. ALIGNMENT SLEEVE: ZIRCONIA (CERAMIC). PULL-OUT FORCE IS 100~300gf.
 3. DUST CAP: ENGINEERING PLASTIC, COLOR WHITE.

- SPECIFICATIONS:**
1. OPERATING TEMPERATURE: -40°C ~ +85°C
 2. CONNECTION DURABILITY: 500 MATEINGS
 3. REPEATABILITY: Δ I.L.<0.1dB
 4. INSERTION LOSS: <0.25dB

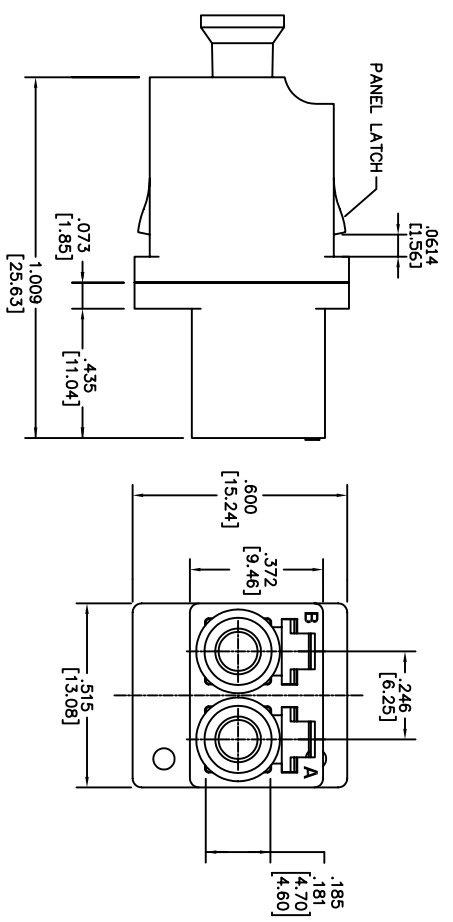
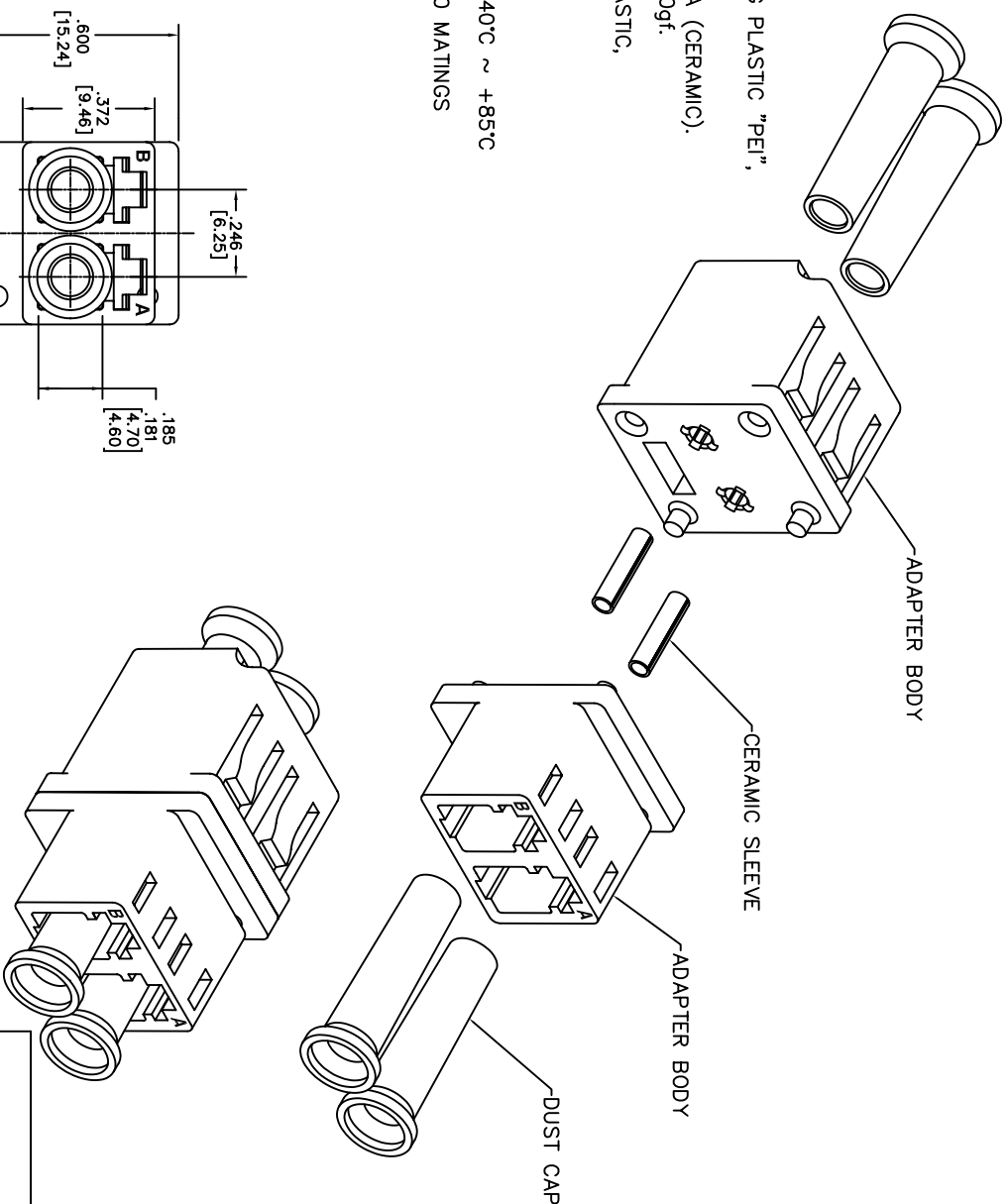

UNIT: INCH [mm]

| | |
|---------------|----------------------|
| Product name: | LC Duplex MM Adaptor |
| P/N: | EA9002 |
| Drawing no. | |